

(Plan 1er étage)

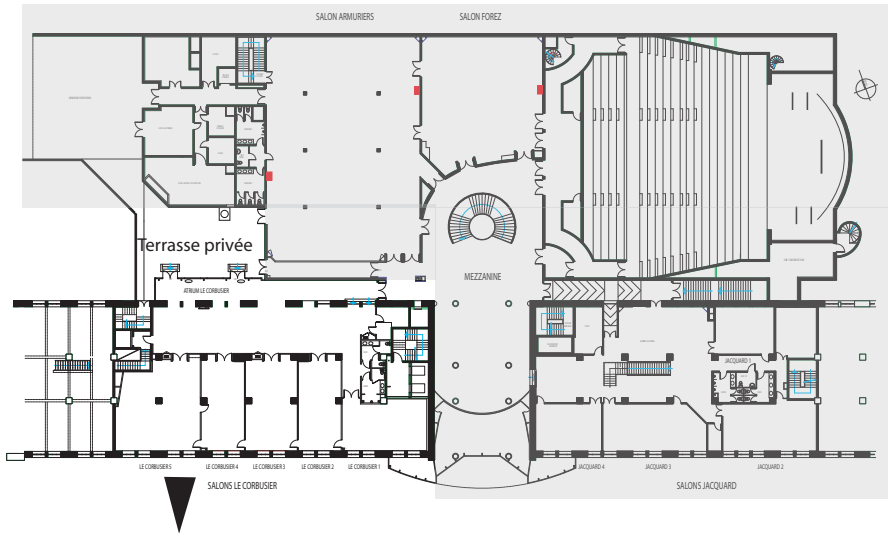

Salons Le Corbusier (1er étage)

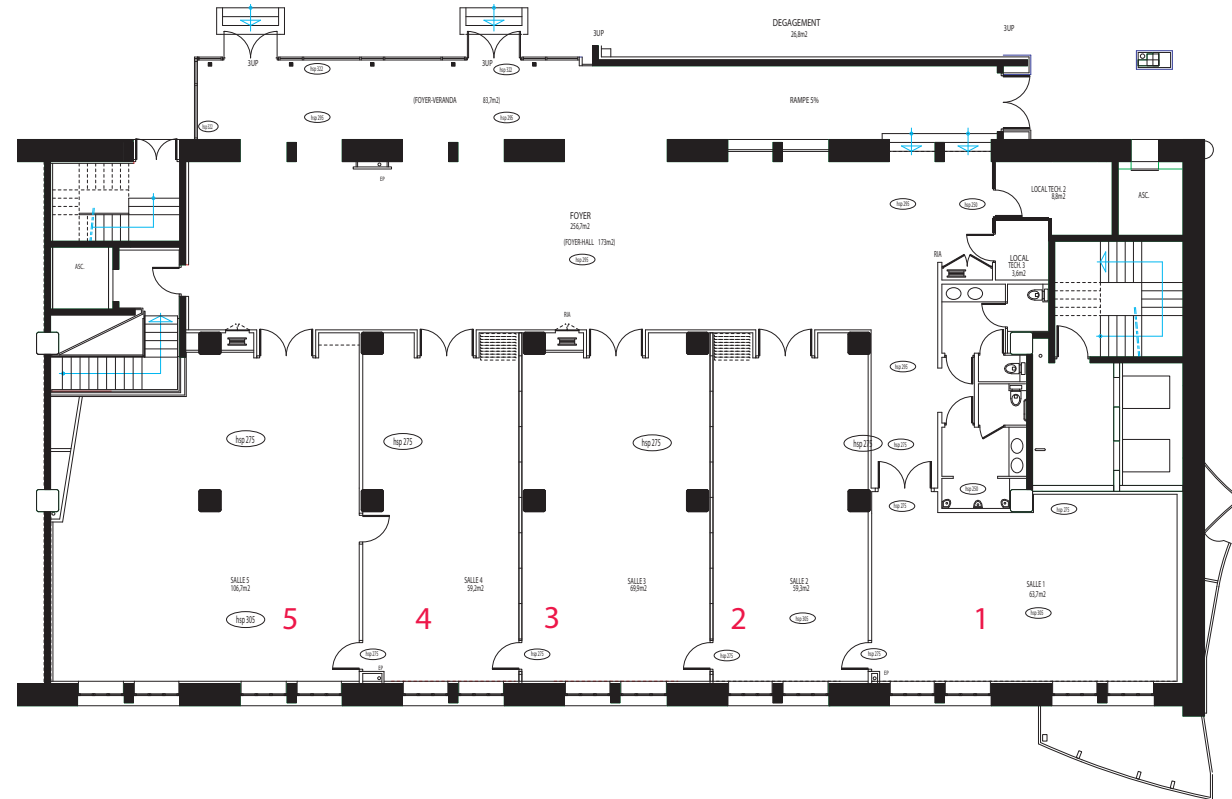

SALONS LE CORBUSIER

| Rez-de-Chaussée | Surface | Surface Exposition | Classe | Théâtre | | Cocktail Pause | Restauration |
|--------------------------|---------|--------------------|--------|---------|----|----------------|--------------|
| Atrium Le Corbusier | 257 m2 | 257 m2 | | | | 200 | 120 |
| Salon Le Corbusier 1 | 64 m2 | 64 m2 | 42 | 64 | 32 | 65 | 60 |
| Salon Le Corbusier 2+3+4 | 190 m2 | 190 m2 | 100 | 160 | 64 | 190 | 160 |
| Salon Le Corbusier 2 | 60 m2 | 60 m2 | 34 | 60 | 28 | 60 | 40 |
| Salon Le Corbusier 3 | 70 m2 | 70 m2 | 38 | 70 | 28 | 70 | 50 |
| Salon Le Corbusier 4 | 60 m2 | 60 m2 | 34 | 60 | 28 | 60 | 40 |
| Salon Le Corbusier 2+3 | 130 m2 | 130 m2 | 68 | 115 | 44 | 130 | 100 |
| Salon Le Corbusier 3+4 | 130 m2 | 130 m2 | 68 | 115 | 44 | 130 | 100 |
| Salon Le Corbusier 5 | 107 m2 | 107 m2 | 56 | 106 | 44 | 110 | 90 |